

**Satel**<sup>®</sup>  
MADE TO PROTECT

**KNX**

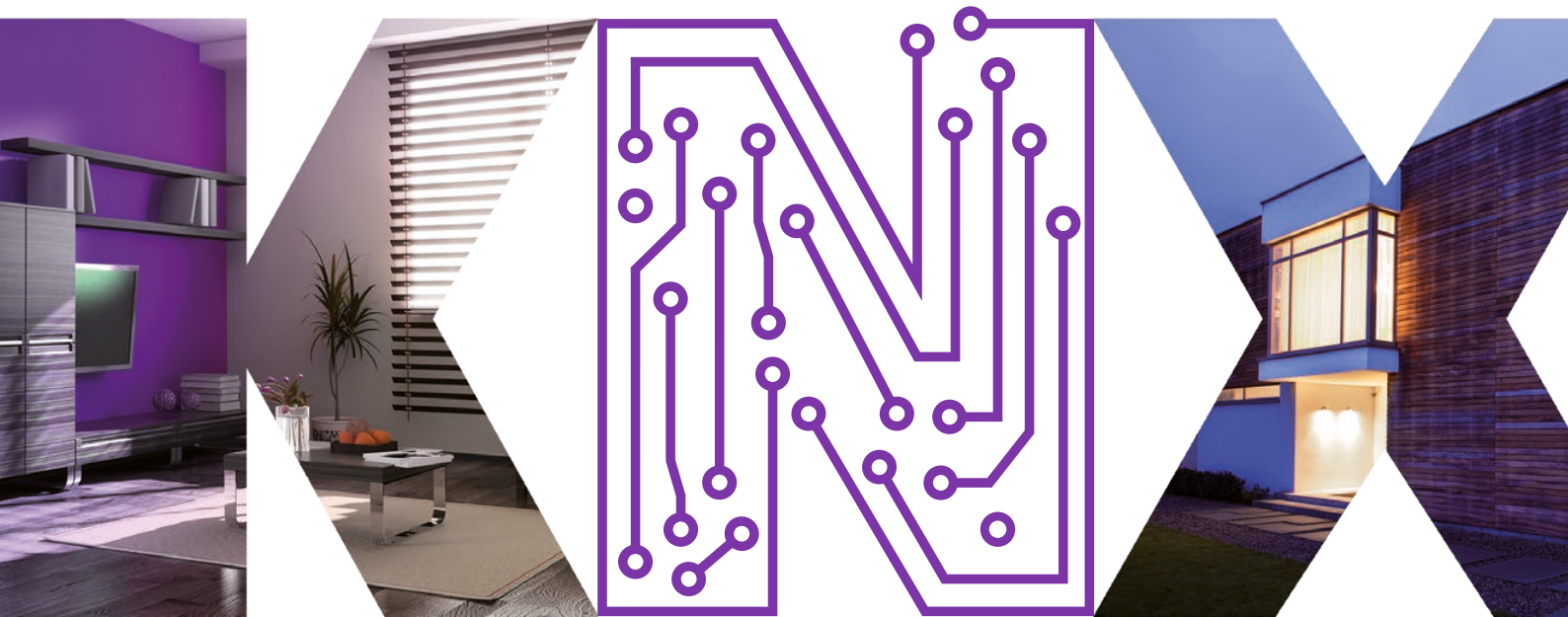

**Building automation  
smart and secure home**

[www.satel.pl](http://www.satel.pl)

# Just imagine...

...an ideal home that makes your every day special. In the morning, it greets you with your favorite music and aroma of freshly brewed coffee, letting into the bedroom the first rays of the sun and a refreshing breath of fresh air. In the evenings, it adjusts itself perfectly to the circumstances, your plans and mood. It is your assistant accompanying you in all your daily activities. It also takes care of your garden so that it can always please your eyes.

...a smart home that perfectly knows all your needs and is able to meet them. It knows, for example, your favorite temperatures in the winter and in the summer. It illuminates each room you enter with a light of appropriate intensity – and turns off the lamps after your exit, because ... it also cares about your wallet!

...a secure home that watches over everything around the clock and protects what is most precious to you – your loved ones.



Smart home



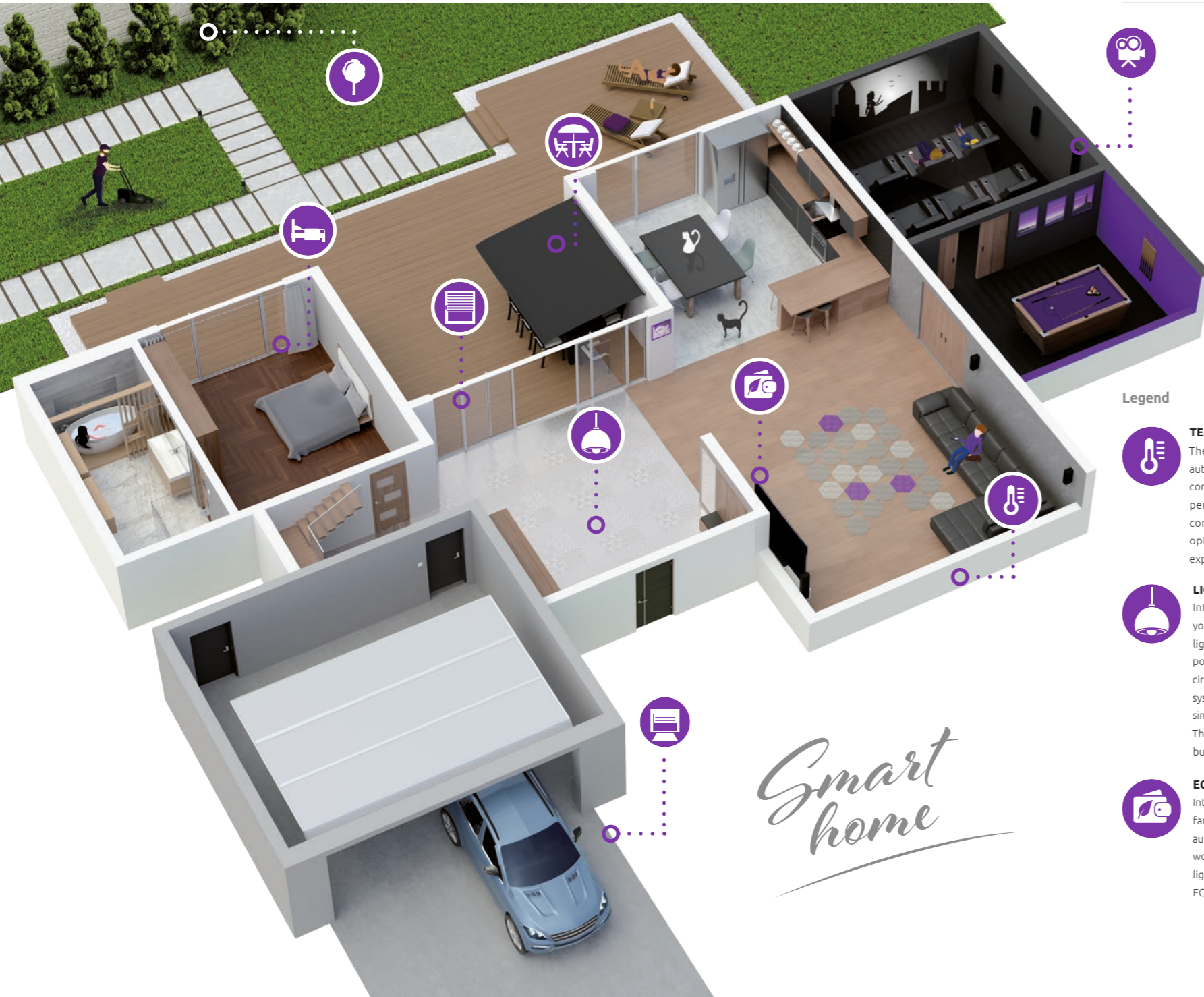

*Smart home*

## KNX system – how it works

Invite modern solutions into your daily life to gain much more than just some extra time. From now on you will not have to worry about anything – your smart home will automatically meet all your wishes. It will do your everyday duties for you, allowing you the pleasure of spending time with your loved ones. The number of its functionalities is infinite. Below are just some examples that we hope will inspire you to create your ideal home.

### Legend



#### TEMPERATURE

The temperature in individual rooms changes automatically to meet your preferences. The system constantly monitors the weather and adjusts the performance of individual systems (heating, air conditioning, blinds) in order to maintain the optimal temperature level according to your expectations.



#### LIGHTING

Intensity and type of lighting will always match your mood! It takes just one click to start a selected light scene. Therefore, the brightness of the light points you choose will immediately adjust to the circumstances. When you leave for vacation, the system will control the lighting in such a way as to simulate the presence of the household members. This simple procedure will discourage potential burglars who might be watching the house.



#### ECOLOGY AND ECONOMY

Intelligent technologies can also take care of the family budget. Leaving the house? The system will automatically turn off devices that do not need to work when you are absent. It will also turn off the lighting, and in winter it will switch the heating into ECO mode to save energy.



#### BEDROOM

For a great start to your day, the system raises the blinds and tilts the window open to let the first rays of sunshine and fresh air into the bedroom. In the meantime, it is brewing for you a cup of aromatic coffee you are craving for. Your favorite music plays in the background. For such mornings, it's worth getting out of bed!



#### MEDIA ROOM

A movie night with friends? Look how the room can change into a modern cinema! In a few moments, the projection screen is lowered and the projector is turned on. All lighting gets dimmed, except for some delicate light spots, for example, above the snack corner. The windows blinds go down, creating the right mood and comfortable viewing conditions. The player starts the movie you have selected.



#### TERRACE

Relaxing on the terrace on a sunny afternoon? The system automatically opens the awning, providing you comfortable shade. In the evening, a romantic garden light comes on, which helps you relax after a day full of challenges. Also, on cooler days you can enjoy the pleasures of resting on the terrace – the system will then start IR heaters that emit pleasant warmth.



#### WINDOWS

Windows in your smart home can be controlled automatically. Depending on the circumstances and the needs of your household, they are automatically opened, tilted or closed. In addition, the control of anti-burglary roller shutters, blinds and electric curtain will adjust the level of window covering to your preferences.



#### DRIVEWAY

Winter morning? The system will take care of heating the driveway, so you do not have any more to clear it from snow yourself. Instead of doing this, you can spend your time having breakfast with your family or for some extra sleep.



#### GARDEN

The garden will always look thriving and fresh! Your smart home also takes care of it by automatically matching the right watering program to the current level of soil moisture. It also sees to it that particular plant species receive exactly as much water as they need. That's why you do not have to think any longer about watering the garden – regardless of whether you are at home or, for example, on vacation.

# Not comfort alone

If, in addition to the smart home functions, you also want security, install an alarm system based on the INTEGRA control panel, which can be easily integrated with the KNX system. Combining both systems into one installation is not only cost-saving but also very convenient solution. You will be able, for example, to locally control all functions using just a single device! Modern touch-screen keypads will add elegance to any interior, and their intuitive graphical interface will make system operation extremely easy and pleasant for all household members.

The INTEGRA CONTROL application installed on your mobile device will also enable you to remotely control the entire system from any location in the world!

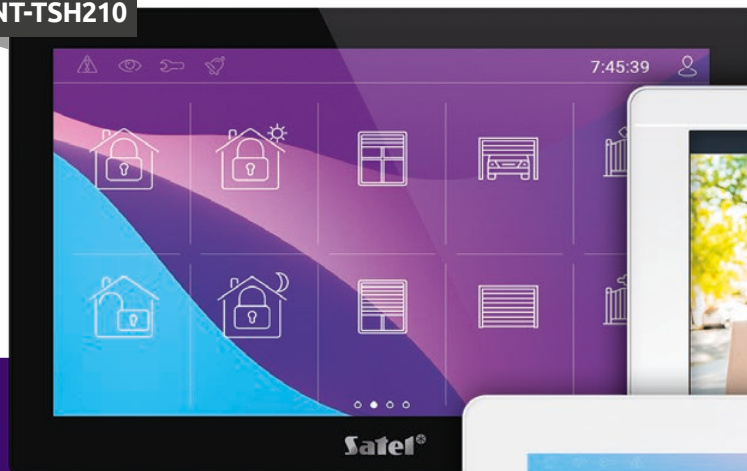
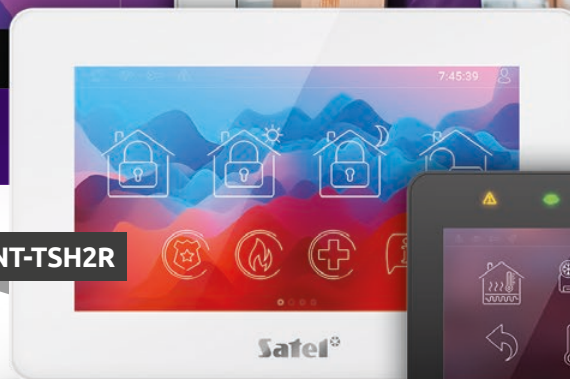
**INT-TSH210****INT-TSI****INT-TSH2R****INT-TSG2R**



## Energy efficiency

Security, convenience and comfort of the household members are not the only benefits resulting from the use of an alarm system and home automation in the KNX standard. Individual tasks, implemented by using this advanced system, will also allow you to save energy. This can in a short time bring you **tangible effects by cutting down your energy bills**. All you have to do is program the system so as to turn off the light in rooms where the motion detectors did not detect your presence for a specified period of time, as well as turn off the heating or air conditioning in the room in which the window was opened.

## Economy

When combining the alarm system with the home automation system in the KNX standard **you do not have to duplicate all devices**. Some of them can serve a dual purpose. Devices whose main task is to provide everyday security (e.g. detectors) can also be used to control home automation. This solution translates into **real savings** which clearly makes the entire installation more cost-effective.

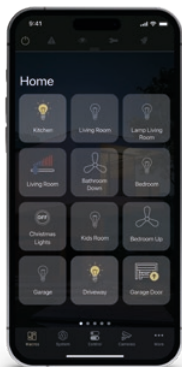

**integra**  
CONTROL



## Time saving

The INTEGRA system will help you save time in specific situations. A gardener or a courier with important parcel appeared in front of your house? Unannounced guests arrived? Or maybe your child has forgotten the keys and keyfob to disarm the alarm? With the INTEGRA CONTROL application you can quickly bring under control any such problem **without unnecessary stress, having to return home or interrupting your daily activities**. Using a smartphone or tablet, you can in a few moments **send a remote command**, for example, to disarm the alarm in the garden, to open the entrance gate or the entrance door. We know that your peace and time are very precious!

**Satel**  
MADE TO PROTECT

Budowlanych 66, 80-298 Gdansk, Poland, tel. +48 58 320 94 00, fax + 48 58 320 94 01, e-mail: trade@satel.pl

The manufacturer reserves the right to change the specification and technical data of devices. Images shown are for general information only and may differ from actual products. U-KNX-KK-EN1125

1

# YOUR PERFECT DAY

- Even before the alarm clock rings, the temperature in the house will adjust to your preferences. In winter, floor heating will also turn on – thus, when you get out of bed, your feet will come in contact with a pleasantly warm floor. In the meantime, the system turns on your favorite music, which gently awakens you from sleep and fills with positive energy.
- You need light to wake up. In summer, the motorized blinds or curtains open smoothly, and in winter, the lamps light up the room gently enough not to dazzle your eyes – you decide yourself what the light intensity should be.
- Fresh air will make you feel better. The window in the bedroom will tilt open automatically or you can do it remotely yourself. Regardless of the option, the system will turn off the heating immediately, and will prevent the temperature from dropping below the level which is comfortable for you.



2

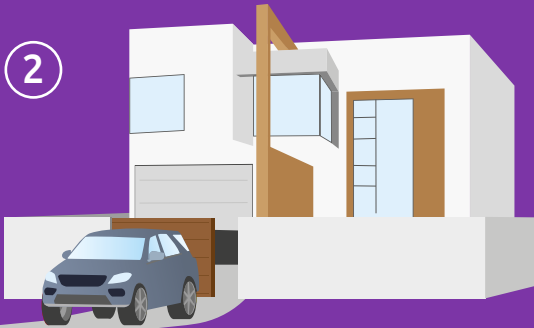

- Leaving for work? The system will close all windows, and also turn off music, lighting and electrical devices indicated by you.
- When you enter the garage, its door will open in front of you. When you drive out, you can see the anti-burglary roller shutters and the garage door close, and the entrance gate open.
- The alarm system is armed – your home is under really vigilant protection now.
- When you are not at home, your system watches over everything. You have nothing to worry about, even during strong wind, rain or storm: you know very well that e.g. the terrace awnings have been automatically rolled up and secured, and the windows are tightly closed.

3

- Even before you are back home at a specific time, the system will adjust the indoor temperature to your expectations. Regardless of the season, it will always be cozy and comfortable in your house!
- At home at last! The alarm system is disarmed. You open the entrance gate using the mobile application or one button on the keyfob, and the driveway gets automatically illuminated. You enter the garage – its door has just opened in front of you.
- You open the front door carrying heavy shopping bags or holding a sleeping baby in your arms? In the dark corridor, lighting automatically comes on and "follows" you when you move from one room to another.



4

- Time for a meal at the table – celebrate the moments with your loved ones! In the background, tranquil music resounds, putting the family in a perfect mood. Above the table, a warm light comes on, the rest of the lighting going dimmed. In the meantime, an electric wall mounted fireplace also turns on, emphasizing the cozy, homely atmosphere.
- Before you go to sleep, all the doors, gates and windows as well as the shutters or blinds automatically close. The alarm system is armed in the night mode.
- In case of night wandering (e.g. to the kitchen), your path is illuminated by lamps that give a delicate glow with intensity sufficient for safe passage. They automatically switch on as soon as they sense your presence.

**When you sleep, the system watches over everything all the time to make your night truly peaceful, so that you are well rested and ready for another day full of challenges.**

